

# 2016년

2016 Annual Spring Scientific Conference of the KSC  
in conjunction with KSIC, KSE, and KSLA

# 춘계심혈관통합학술대회

대한심장학회 | 대한심혈관중재학회 | 한국심초음파학회 | 한국지질·동맥경화학회

& The 8<sup>th</sup> Asian Pacific Congress of Heart Failure  
제8회 아시아·태평양 심부전학술대회

*One Heart,  
One Life*



April 15 ▶ 16

HICO, Gyeongju, Korea

# All Empowering Therapies\* with Full MRI Access



\*Pacing, ICD, and CRT systems

# Medtronic

## Greeting

천년의 역사를 이어가는 Golden City, 경주에서 4월 15일(금)-16일(토) 양일간 2016년 춘계 심혈관 통합학술대회를 개최합니다. 총 4개 학회 (대한심장학회, 대한심혈관중재학회, 한국 심초음파학회, 한국지질동맥경화학회) 및 APCHF 2016 (아시아태평양 심부전 학회)의 심장학 연구자들을 위해 새로운 배움의 기회를 만들고자 국내외 저명한 학자들의 강연과 토론의 자리를 마련하였습니다.

심장학은 우리나라 의학 역사상 가장 눈부신 발전을 이루어낸 분야입니다. 또한 최근에는 급속한 고령화로 인해 의료수요가 증가하면서 심장학에 대한 국가적 관심과 국민의 기대가 날로 높아지고 있는 상황입니다. 이처럼 중요한 시기인 만큼 좀 더 나은 치료 지침을 개발하기 위하여 심장학 연구에 박차를 가하고 서로 협력하는 자세가 필요할 것으로 사료됩니다.

이번 학술대회는 그러한 시대적 요구에 부합하여 심장학이 더욱 발전하기를 바라는 마음으로 준비하였으며, 국내에서 개최하는 규모 있는 통합학술대회인 만큼 다양하고 유익한 주제를 다룰 수 있도록 노력하였습니다.

2015년 선포한 비전, 미션, 핵심가치를 실현하도록 방향을 설정하고 이에 발맞춘 학술 프로그램을 접목시켜, 궁극적으로는 국민건강증진에 이바지하는 "사회적 책임을 다하는 심장학회"가 되기 위해 노력하고 있습니다.

세계적인 석학을 모셔 담론을 나누는 Plenary Session을 비롯하여 심장학 전반의 최신 의학 지견을 담은 분야별 심포지엄, 그리고 의학과 첨단 기술의 융합을 한 눈에 볼 수 있는 다양한 정책세션에 이르기까지, 다양한 참가자들의 만족도를 높이기 위해 많은 노력을 기울였습니다.

심장학에 종사하는 많은 연구자들에게 심장학 연구의 저변을 넓히고 기초, 역학 및 임상 부문의 연구가 활성화 될 수 있는 발판을 마련하는 교육의 장이 되고자 하였으며, 궁극적으로는 심장병으로 고통 받는 환자들이 질병으로부터 벗어날 수 있도록 최신 의학 지견을 다각적으로 소통하여 국민건강의 증진을 위해 한 발 더 나아갈 수 있도록 돕는 뜻 깊은 자리가 되기를 소망합니다.

존경하는 회원님과 심장학의 발전을 위해 늘 수고하시는 선생님들의 많은 참여 부탁드립니다.



대한심장학회  
회장 고재기



대한심장학회  
이사장 오병희

## Opening Hours

	Open	Close	Venue
<b>Preview Room</b>	07:30	17:30	2F Rm.206
* 발표자료는 발표 2시간 전까지 접수하시기 바랍니다.			
<b>Registration</b>	07:30	17:30	1F Lobby
<b>Members' Lounge</b>	07:30	17:00	3F Rm.300 B
<b>Exhibition Hall</b>	09:00	17:00	1F Hall 1-2

www.ksc2016.or.kr

*One Heart, One Life*

# KSC 2016

대한심장학회 제60차 추계학술대회

The 60<sup>th</sup> Annual Scientific Meeting of The Korean Society of Cardiology

2016년 9월 25일(일) - 27일(화)

인터컨티넨탈 호텔 코엑스 B1

초록접수 마감일 6월 2일(목)



**KSC 2016-Hypertension Seoul 2016 동시개최 조기등록 안내**

**기간** 5월 31일(화) 까지    **혜택** 2개의 학술대회에 등록 인정

**방법**

1. Hypertension Seoul 2016 홈페이지에서 온라인 등록
2. 2016년 춘계심혈관통합학술대회 현장에서 등록

# H

## Highlight Program

### Plenary Session

April 15 | 10:20-11:10 | Rm.300C

#### Working Harder for a Healthier Heart and Vessel

Strategic Approaches to Minimize Sudden Cardiac Death in Our Society

Sumeet S. Chugh / Cedars-Sinai Medical Center, USA

The Establishment of Regional Clinical Practice Guidelines for Optimal CVD Risk Management

Geneviève Derumeaux / Lyon Univ., France

### KSC-JCS Joint Session

April 15 | 11:20-12:40 | Rm.103

#### Target Blood Pressure for Asian Population

Strategies to Achieve Target Blood Pressure in Asians with Resistant Hypertension

Jitsuo Higaki / Ehime Univ., Japan

#### Target Blood Pressure for the Elderly Systolic Hypertension

Cheol Ho Kim / Seoul National Univ., Korea

#### Management of Elderly Hypertension Beyond Target Blood Pressure

Hiromi Rakugi / Osaka Univ., Japan

#### New Answers from the Recent Study Results

Sung Ha Park / Yonsei Univ., Korea

Suh, Soon-Kyu Memorial Lecture

April 16 10:20-11:10 Rm.300C

Breakthrough from Failing Hearts

Global Epidemics of Heart Failure

Mary Norine Walsh / St. Vincent Health Center, USA

Multidisciplinary Approaches to Heart Failure Management: Targeting Comorbidities

Stefan D. Anker / Medical University Goettingen, Germany

의료정책

April 15 14:20-15:50 Rm.205

의료적정성 평가

The Gaps and Compatibility of Ethical Policy and Effective Study

유소영 / 서울아산병원

요양급여 적정성평가의 주요내용 및 추진방향

장태영 / 보건복지부

K-PCI Registry 경과보고

한규록 / 한림의대

Canadian Healthcare System Performance Indicators Including AMI and Reporting Methods

Hude Quan / University of Calgary, Canada

심평원이 시행한 급성심근경색증 평가사업의 평가 연구용역 공청회

김석일 / 가톨릭의대

15 Day 1 2016. 04. 15. Fri.

Program at a glance

Day 1

		08:30-09:50	09:50-10:20	10:20-11:10	11:20-12:40	12:40-13:20	13:20-14:20	14:20-15:50	15:50-16:20	16:20-18:00	
1F	H Rm.102	KSIC 1 All You Need to Know: Non Invasive Evaluation for Chest Pain	Break	Key Note KSIC What you Have to Learn	KSIC 2 All About BVS	Scientific Session: Daiichisankyo-Daewoong New Anticoagulation Therapy for NVAf Patients	Lunch & Break	KSE 1 Issue & Updates in Myocardial & Pericardial Disease	Break	KSE 2 Learning from Cases & Echocardiography [1]	
	E Rm.103	Hypertension Insights from Systolic Blood Pressure Intervention Trial (SPRINT)		KSC-JCS Joint Session Target Blood Pressure for Asian Population	Scientific Session: Boryung Optimal BP Control: Hot Issue of Hypertention	Myocardial Infarction Practical Questions in the Management of Acute Myocardial Infarction		Arrhythmia 3 How to Session: Only Technical Issues			
	A Rm.105	08:30-10:10 KSLA 1 Autophagy and Atherosclerosis		11:10-12:40 KSLA 3 Nutrition Session: Nutrition and Atherosclerosis	Scientific Session: Pfizer Heart & Brain: A Call for the Holistic Management	14:20-16:00 KSLA 4 Lessons Learned from Recent CV Outcome Trials		16:10-18:00 KSLA 5 Special Debate Session: Do We Need Surrogate Markers or Not?			
2F	R Rm.205	Break	KSLA 2 Key Note Lecture	Surgery Surgery and Intervention for Severe Aortic Stenosis	Diamond Boehringer Ingelheim Looking Back & Assessing Real-World Data of Dabigatran in Korea	의료정책 의료적정성 평가	Clinical Study Design to Analysis; Essentials for Cardiologists Implementing Cardiovascular Clinical Study	Break	Myocardial Infarction Cutting-Edge Management of Acute Myocardial Infarction		
	T Rm.300C Main Arena									Arrhythmia 1 Interesting ECG: ECG Strol from Sinus to Papillary Muscle	Plenary Session Working Harder for a Healthier Heart and Vessel
2F	Rm.202	Heart Failure with Preserved EF: What We Know	Break	Plenary Session	Acute Heart Failure: Current and Future Management on the Horizon	Scientific Session: Bayer The Evolving World of Anticoagulation: Atrial Fibrillation and Heart Failure	Lunch & Break	APHRs-APCHF CIED (Cardiac Implantable Electronic Devices) in Heart Failure	Break	Challenges in Treatment of HF	Current Concept in HF Diagnosis and Management: Where We Stand
	Rm.203	Translational Research in Heart Failure		Scientific Session: Otsuka Emerging Concepts about Treatment of Congestive Heart Failure	Cardiac Rehabilitation & Patient Education in HF: Why and How We Do	The Global HF Epidemics		Advanced Heart Failure Management: Shared Experience and Evidence from the World			
	Rm.204			General Review I		Oral Abstract Presentation I		Hands on Tutorial: ECMO and LVAD		Recent Updates in the Management of Pulmonary Hypertension	

- KSC 대한심장학회
- KSIC 대한심혈관중재학회
- KSE 한국심초음파학회
- KSLA 한국지질·동맥경화학회
- APCHF 아·태 심부전학회

Guide Map HEART Rooms

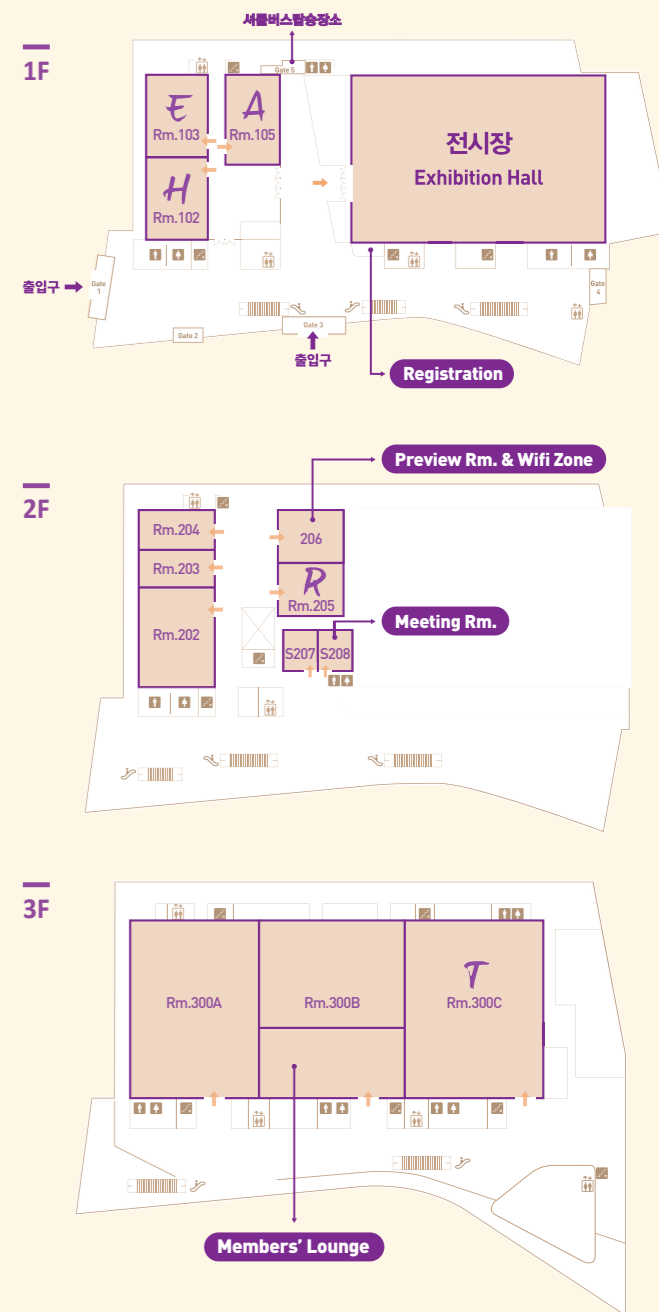

# Day 2 2016. 04. 16. Sat.

- KSC 대한심장학회
- KSIC 대한심혈관중재학회
- KSE 한국심조음파학회
- KSLA 한국자질·동맥경화학회
- APCHF 아·태 심부전학회

		08:30-09:50	09:50-10:20	10:20-11:10	11:20-12:40	12:40-13:20	13:20-14:20	14:20-15:40	15:50-17:20
1F	<b>H</b> Rm.102	KSE 3 Issue & Updates in Valvular Heart Disease	Break	Basic Research Key Note Lecture	KSE 4 Learning from Cases & Echocardiography [2]	Scientific Session: MSD Challenging LDL-C Treatment Especially on ACS Patients	Lunch & Break	Women Microvascular Angina and Gender	Nursing in Cardiac Critical Care Units New Trend of Cardiology Nursing Intervention
	<b>E</b> Rm.103	Arrhythmia 4 Case-Based Tutorial: Practical Issues in NOAC			Arrhythmia 5 Debate: Post-STAR AF2	Scientific Session: AstraZeneca Address the CAD Challenge; The Patient-Centric Approach of Statin and OAP Treatment		Basic Research Regeneration and Metabolism	Basic Research Signaling
	<b>A</b> Rm.105	Pediatric Cardiology Pediatric Infective Endocarditis; The Update			Pediatric Cardiology Pericardial Disease in Children	Scientific Session: Samjin Focus on Rosuvastatin Under the Current Treatment Guideline of Hypercholesterolemia		Adult Congenital Heart Disease Changing Mortality and Morbidity	Pediatric & Congenital Cardiac Surgery Debate on the Management of LV Outflow Tract Issues
2F	<b>R</b> Rm.205	Diamond BAYER The Evolution of Clinical Management in PH: Perspectives on Treatment Approaches	Imaging Imaging of the Coronary Arteries and Ischemic Hearts: Current Issues	Smart Cardiovascular Healthcare	Vascular Functional Assessment from Non-Invasive Imagings of Atherosclerotic Vascular Beds	Adherence for Cardiovascular Disease Patients, "1 pill"	Smart Cardiovascular Healthcare	Arrhythmia 6 Case Based Tutorial: Hypertrophic Cardiomyopathy	Arrhythmia 7 Debate: Valvular AF
3F	<b>T</b> Rm.300C Main Arena	KSIC 3 Forgotten Vessel; Vein	Suh, Soon-Kyu Memorial Lecture Breakthrough from Failing Hearts	KSIC 4 Beyond Coronary Angiography	Scientific Session: Novartis	Scientific Session: Bayer	Arrhythmia 6	Arrhythmia 7	
2F	Rm.202	AAE-APCHF State of the Art Cardiac Imaging and Heart Failure	Break	Plenary Session	HFA-APCHF The Global Heart Failure Problems: Prevention, Aging and Quality	Lunch & Break	Biomarkers: from Old Marker to Novel Marker	Closing Remark and Awards	
	Rm.203	Ethnic and Sex Difference: Is This Real?			ACC-APCHF Guideline Driven Heart Failure: Contemporary Perspectives and Future Considerations				Cardiomyopathies: 2016 Update
	Rm.204	General Review II			General Review III in HF: Case Based Learning in HF Management				Oral Abstract Presentation II

Eng English GER Germany JPN Japan USA United States of America

## Guide Map HEART Rooms

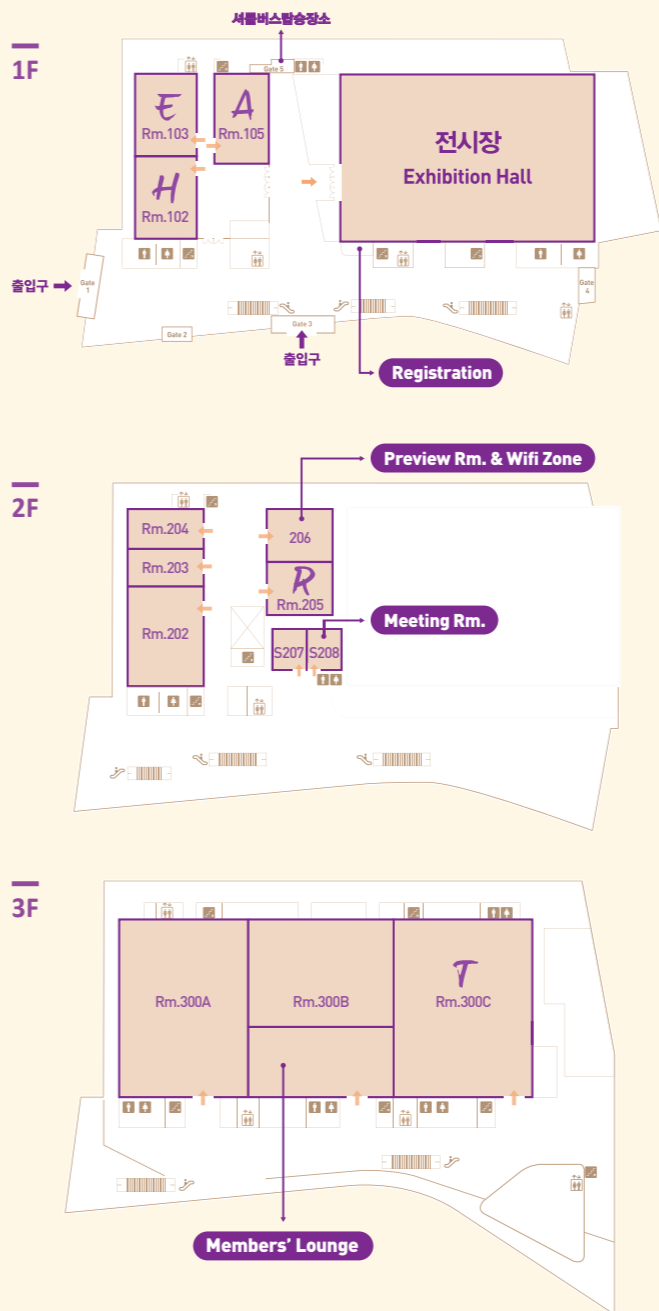

## Attendance Guide

### 식사제공안내

Scientific Session 참석시 식사쿠폰 제공

Scientific Session 참석

세션 종료 후 식사쿠폰 수령

300A(3층)로 이동 후 식사

### 셔틀버스 이용안내

- 노선1 신경주역(KTX)
- 노선2 경주시외버스터미널
- 노선3 현대 호텔
- 노선4 코모도 호텔

경주 하이코  
탑승장소  
Gate5 버스주차장

소요시간은 도로사정에 따라 변경될 수 있는 점 양해 부탁드립니다.

노선 1 신경주역(KTX) ↔ 하이코 차량 50분 소요(편도)

노선 2 경주 시외버스터미널 ↔ 하이코 차량 40분 소요(편도)

신경주역 출발	하이코 출발
10:30	12:40
11:30	15:00
14:50	16:40
15:50	17:30
16:40	

버스터미널 출발	하이코 출발
07:00	14:50
08:30	16:30
10:00	18:10
11:30	
14:00	
15:40	
17:20	

노선 3 현대 호텔 ↔ 하이코 차량 5분 소요(편도)

노선 4 코모도 호텔 ↔ 하이코 차량 5분 소요(편도)

현대호텔 출발	하이코 출발
08:00	15:45
08:10	16:45
08:20	17:45
08:40	18:15
09:00	18:45
09:30	
10:00	
11:30	
15:30	
16:30	

코모도 호텔 출발	하이코 출발
08:10	18:20

## 등록 안내



### 등록비

	사전등록	현장등록
교수 및 개원의	100,000원	120,000원
전임의, 전공의, 기타	70,000원	90,000원
65세 이상, 의과대학 재학생	무료	무료

### 등록 방법

#### 사전등록

메일 수신 및 출력한 바코드 혹은 문자로 수령한 바코드를 가지고 사전 등록처에서 명찰을 수령 받습니다.

#### 현장등록

현장등록 신청서 기재 후 현장 등록처에서 명찰을 수령 받습니다.

## 평점 등록 안내



대한의사협회 [제2016-1호] 연수교육 지침에 따라, 본인 여부 및 출결 사항 확인을 시행합니다. (2016년 2월부터)

### 1. 1일 2회 명찰 바코드 인식(입,퇴장 확인), 체류시간에 따라 평점 인정

평점 인정 기준	체류시간					
	- 2시간 이하	2시간 초과 - 3시간 이하	3시간 초과 - 4시간 이하	4시간 초과 - 5시간 이하	5시간 초과 - 6시간 이하	6시간 초과
평점 인정	0 평점	3 평점	4 평점	5 평점	6 평점	6 평점

※ 입, 퇴장 확인 : 등록처 기계에 명찰 바코드 인식

### 2. 주의사항

	구분	입장	퇴장	평점
(1) 퇴장 확인 시 화면에 안내되는 체류시간 및 인정되는 평점을 꼭 확인 하시기 바랍니다.	Case 1	인식 ○	인식 X	불인정
(2) 1일 1회만 확인될 시 평점이 불인정 되므로, 불이익을 받는 사례가 없도록 유의하여 주시기 바랍니다.	Case 2	인식 X	인식 ○	불인정
	Case 3	인식 ○	인식 ○	인정

### 3. 2016년 춘계심혈관통합학술대회에서는 1일 최대 6점까지 평점 인정됩니다.

## General Information

### Coffee



1F Exhibition Hall 09:00-17:30

2F Conference Rm. Lobby 09:00-17:30

3F Cafe Lounge 09:00-17:30

### Concierge



1F Information Desk 07:30-17:30

### Sponsors



Diamond



Platinum



Gold



Silver



## International Invited Faculty

### 대한심장학회

#### Plenary Session

#### Suh, Soon-Kyu Memorial Lecture



Sumeet S. Chugh  
Cedars-Sinai  
Medical Center, USA



Geneviève  
Derumeaux  
Lyon University, France



Mary Norine Walsh  
St. Vincent  
Health Center, USA



Stefan D. Anker  
Medical University  
Goettingen, Germany

#### Symposium



Chun-Chieh Wang  
Chang Gung University,  
Taiwan



Naoki Mochizuki  
National Cerebral and  
Cardiovascular Center  
Research Institute, Japan



Stephen Nicholls  
University of Adelaide,  
Australia



Amy W. Pollak  
Mayo Clinic, USA



Jitsuo Higaki  
Ehime University, Japan



Hiromi Rakugi  
Osaka University, Japan



Masaru Miura  
Tokyo Metropolitan  
Children's Medical Center,  
Japan



Kiwon Ban  
City University of Hong Kong,  
Hong Kong

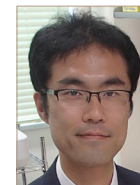

Ippei Shimizu  
Niigata University, Japan

### 대한심혈관중재학회



Michael Park  
Cleveland Clinic, USA



Ik Kyung Jang  
Massachusetts  
General Hospital, USA



Jae K. Oh  
Mayo Clinic, USA

### 한국지질·동맥경화학회



Koji Yamano  
Tokyo Metropolitan  
Institute of Medical  
Science, Japan



Yasufumi Sato  
Tohoku University, Japan

## Program KSC 대한심장학회

**15** April 15 Fri.  
**08:30-09:50**

### Hypertension

Rm.103

#### Insights from Systolic Blood Pressure Intervention Trial (SPRINT)

Chairpersons: 박창규, 신진호

**08:30-08:50** Hypertension Specialist's View

박성하/연세의대

**08:50-09:10** Heart Failure Specialist's View

이상연/서울의대

**09:10-09:30** Stroke Specialist's View

권순익/울산의대

**09:30-09:50** Nephrologist's View

김세중/서울의대

### Arrhythmia 1

Rm.300C

#### Interesting ECG: ECG Strol from Sinus to Papillary Muscle

Chairperson: 조용근

Panel: 광중환, 김준수

**08:30-08:45** From Sinus Node to AV Node: Bradycardia

최종일/고려의대

**08:45-09:00** ECG Basics

한상진/한림의대

**09:00-09:15** From HIS to Ventricle: Normal & Abnormal Conduction

김대혁/인하의대

**09:15-09:30** What's Wrong in Ventricular Repolarization?

남기병/울산의대

**09:30-09:40** Discussion

**10:20-11:10**

### English Plenary Session

Rm.300C

#### Working Harder for a Healthier Heart and Vessel

Chairperson: Byung-Hee Oh

**10:20-10:45** Strategic Approaches to Minimize Sudden Cardiac Death in Our Society

Sumeet S. Chugh/Cedars-Sinai Medical Center, USA

**10:45-11:10** Latest EUROASPIRE Surveys Reveal Continuing Health Concerns

Geneviève Derumeaux/Lyon University, France

**11:20-12:40**

### English KSC-JCS Joint Session

Rm.103

#### Target Blood Pressure for Asian Population

Chairpersons: Jitsuo Higaki, Soon Gill Kim

**11:20-11:40** Strategies to Achieve Target Blood Pressure in Asians with Resistant Hypertension

Jitsuo Higaki/Ehime Univ., Japan

**11:40-12:00** Target Blood Pressure for the Elderly Systolic Hypertension

Cheol Ho Kim/Seoul National Univ., Korea

**12:00-12:20** Management of Elderly Hypertension Beyond Target Blood Pressure

Hiromi Rakugi/Osaka Univ., Japan

**12:20-12:40** New Answers from the Recent Study Results

Sung Ha Park/Yonsei Univ., Korea



## Surgery

Rm.205

### Surgery and Intervention for Severe Aortic Stenosis

Chairpersons: 장병철, 송재관

- 11:20-11:30** Adequate Evaluation of Aortic Valve and Root. Radiologist's Aspect  
이활/서울의대
- 11:30-11:40** How to Recommend Optimal Treatment Modality? Viewpoint of Echo Specialist  
홍그루/연세의대
- 11:40-11:55** Surgical Aortic Valve Replacement. Are There any Contra-indications?  
박표원/성균관의대
- 11:55-12:10** Role of TAVI(TAVR) in Current Era  
유철웅/고려의대
- 12:10-12:25** Role of Sutureless/Rapid Deployment Valve Replacement  
김경환/서울의대
- 12:25-12:40** Discussion

## English Arrhythmia 2

Rm.300C

### CIED Therapy in HF Management

Chairperson: Kee Joon Choi  
Panel: Dong Jin Oh, In Seok Choi

- 11:20-11:35** CRT Super-Responders: Pre-OP Selection & Post-OP Rhythm Manage  
Boyoung Joung/Yonsei Univ., Korea
- 11:35-11:50** Management of Atrial Arrhythmia Detected in HF-CIED  
Sumeet S. Chugh/Cedars-Sinai Medical Center, USA
- 11:50-12:05** What's New? 2015 HRS/EHRA/APHRS Expert Consensus for ICD Programming & Testing  
Chun-Chieh Wang/Chang Gung Univ., Taiwan
- 12:05-12:20** What's New? 2015 ESC Guidelines for VT Management  
Ki Hong Lee/Chonnam National Univ., Korea
- 12:20-12:30** Discussion

## 12:40-13:20

### Scientific Session- Daiichisankyo & Daewoong

Rm.102

#### New Anticoagulation Therapy for NVAf Patients

Chairpersons: 김준수, 백상홍

- 12:40-13:10** Edoxaban, Engaging with the Real World  
윤영근/성균관의대

### Scientific Session- Boryung

Rm.103

#### Optimal BP Control: Hot Issue of Hypertention

Chairpersons: 송재관, 최동훈

- 12:40-13:00** The Lower, the Better?  
윤영원/연세의대
- 13:00-13:20** Clinical Characteristics and Medication Satisfaction of Kanarb Tablet in Korean Hypertensive Patients: a Prospective, Cross-sectional and Open Label 8 Weeks Switching Study; K-HEMS Study  
이창훈/보훈병원

### Scientific Session- Pfizer

Rm.105

#### Heart & Brain: A Call for the Holistic Management

Chairpersons: 장양수, 최기준

- 12:40-13:00** Optimizing Strategies for CV Risk Reduction in Patients with ASCVD: When and How  
남창욱/계명대
- 13:00-13:20** What's New for Anticoagulation in Non-Valvular Atrial Fibrillation in 2016?  
김남호/원광의대

## Scientific Session- Boehringer Ingelheim

Rm.300C

### New Innovations in Patient Care in Cardiology: A Look Behind the Headlines

Chairpersons: 김영훈, 김효수

**12:40-13:00** EMPAGo: Much Heat, Green Light!  
이철환/울산의대

**13:00-13:20** Idarucizumab: New innovation in Anticoagulation Care  
한성욱/계명대의대

## 13:20-14:20

## Diamond Session-Boehringer Ingelheim Rm.205

### Looking Back & Assessing Real-World Data of Dabigatran in Korea

Chairpersons: 조정관, 최동훈

**13:20-13:40** Experience with NOAC in High Risk Bleeding Patients at Severance Hospital  
정보영/연세의대

**13:40-14:10** Sharing Treatment Experience with Dabigatran at Chonnam National University Hospital  
이기홍/전남의대

## 14:20-15:50

## Myocardial Infarction Rm.103

### Practical Questions in the Management of Acute Myocardial Infarction

Chairpersons: 김종진, 김효수

**14:20-14:35** Reperfusion Injury: How Can We Reduce It?  
조현재/서울의대

**14:35-14:50** Management of LV Thrombus After Primary PCI for STEMI  
고진신/경상의대

**14:50-15:05** Deferred vs. Immediate Stenting in STEMI  
최영진/세종병원

**15:05-15:20** AMI with Non-Culprit Stenosis, How Can We Assess Functional Significance of the Lesions?  
남창욱/계명대의대

**15:20-15:40** Discussion

## 의료정책

Rm.205

### 의료적정성 평가

Chairperson: 한규록

**14:20-14:40** The Gaps and Compatibility of Ethical Policy and Effective Study  
유소영/서울아산병원

**14:40-15:00** 요양급여 적정성평가의 주요내용 및 추진방향  
장태영/보건복지부

**15:00-15:10** K-PCI Registry 경과보고  
한규록/한림의대

**15:10-15:30** Canadian Healthcare System Performance Indicators Including AMI and Reporting Methods  
Hude Quan/University of Calgary, Canada

**15:30-15:50** 심평원이 시행한 급성심근경색증 평가사업의 평가 연구용역 공청회  
김석일/가톨릭대의대

## English Cardiometabolic Syndrome Rm.300C

### Metabolic Syndrome and CVD Risk

Chairpersons: Kwang Kon Koh, Ick-Mo Chung

Panel: Eung-Ju Kim, Sang-Hak Lee, Jeahuk Choi

**14:20-14:40** HDL-Targeted Therapy in MS: HDL-Level vs. HDL-Function  
Kwang Kon Koh/Gachon Univ., Korea

**14:40-14:55** Discussion

**14:55-15:10** Gender Difference of Socioeconomic Risk Factor of Metabolic Syndrome in Korea  
Bo Hyun Kim/Pusan National Univ., Korea

**15:10-15:25** Impact of Metabolically Healthy Obese vs. Non-Obese but Metabolic Syndrome on CVD  
Seong Hwan Kim/Korea Univ., Korea

**15:25-15:40** Cross-Link Between Insulin Resistance, NAFLD and Cardiac Steatosis

Kyoung Im Cho/Kosin Univ., Korea

**15:40-15:50** Discussion

## 16:20-18:00

### Arrhythmia 3

Rm.103

#### How to Session: Only Technical Issues

Chairperson: 박경민

Panel: 김윤년, 오용석

**16:20-16:40** New Technology for Complete & Permanent PV Isolation

박형섭/계명대

**16:40-17:00** New Technology to Minimize Radiation

김준/울산대

**17:00-17:20** How to Avoid Complication of AF Ablation?

박희남/연세대

**17:20-17:40** How to Select Sweet Spot for CRT in Small & Tortuous Veins

박승정/성균관대

**17:40-17:50** Discussion

### Clinical Study Design to Analysis; Essentials for Cardiologists

Rm.205

#### Implementing Cardiovascular Clinical Study

Chairpersons: 강덕현, 김장영

**16:20-16:40** Dealing with Missing Data: Practical Use of Multiple Imputation

장명진/서울대

**16:40-17:00** Understanding Design of Randomized Controlled Trials: Non-Inferiority, Equality, Superiority Design

김태훈/가톨릭대

**17:00-17:20** Understanding Propensity Score Based Adjustment: Matching, PS-Adjusted Multivariate Analysis, Inverse Probability Weighted Analysis

이주명/성균관대

**17:20-17:40** Assessment of Intra- and Inter-Observer Variability

박준빈/서울대

### Myocardial Infarction

Rm.300C

#### Cutting-Edge Management of Acute Myocardial Infarction

Chairpersons: 채성철, 정명호

**16:20-16:40** Reducing Door-to-Balloon Time, Is It Really True Answer?

최철웅/고려대

**16:40-17:00** Traditional & Emerging Medical Treatment for STEMI

박중선/영남대

**17:00-17:20** Revisit of Beta-Blocker in AMI

한정규/서울대

**17:20-17:40** Current Status of Cell Therapy for STEMI

강현재/서울대

**17:40-18:00** Contemporary Practice for STEMI and Temporal Trends of Patients Outcomes

신은석/울산대

**18:00-18:10** Discussion

## Program KSC 대한심장학회

**16** April 16 Sat.  
**08:30-09:50**

### Arrhythmia 4 Rm.103

#### Case-Based Tutorial: Practical Issues in NOAC

Chairperson: 이명용  
Panel: 김대경, 조정관

- 08:30-08:50** Keynote Lecture: NOAC, Status of Quo  
오세일/서울의대
- 08:50-09:10** Case 1. Think Twice Before Prescribing or Skipping NOAC  
김남호/원광의대
- 09:10-09:30** Case 2. NOAC in Patients with CAD  
한성욱/계명의대
- 09:30-09:50** Case 3. Major Bleeding Hx During Anticoagulation  
윤남식/전남의대

### Pediatric Cardiology Rm.105

#### Pediatric Infective Endocarditis; The Update

Chairpersons: 권태찬, 이형두  
Panel: 김성훈, 이영석, 조영국

- 08:30-08:45** Epidemiology of Infective Endocarditis in Children  
김성혜/한림의대
- 08:45-09:00** Biomarkers for The Diagnosis of Infective Endocarditis  
이상윤/세종병원
- 09:00-09:15** Role of Echocardiography in Infective Endocarditis  
윤신원/중앙의대
- 09:15-09:30** Surgical Indication of Infective Endocarditis in Children  
이철/가톨릭의대

- 09:30-09:45** Prophylaxis of Infective Endocarditis for Congenital Heart Disease  
이동식/동국의대

**09:45-09:50** Discussion

### Diamond Session-Bayer Rm.205

#### The Evolution of Clinical Management in PH: Perspectives on Treatment Approaches

Chairperson: 김덕경

- 08:30-09:00** Chronic Thromboembolic Pulmonary Hypertension: The Link Connecting PE with PH  
최정현/부산의대
- 09:00-09:30** A New Class of Treatment in Pulmonary Hypertension-What Could "Riociquat" Mean to Your PAH and CTEPH Patients?  
장성아/성균관대의대

**10:20-11:10**

### English Basic Research Rm.103

#### Key Note Lecture

Chairpersons: Yang Soo Jang, Myeong-Chan Cho  
Panel: Yu Yook Kwon, Sung Ryul Lee, Kyoung Im Cho

- 10:20-11:00** Contribution of the Research Using Zebrafish to Investigating Cardiogenesis and Heart Failure  
Naoki Mochizuki/National Cerebral and Cardiovascular Center Research Institute, Japan
- 11:00-11:10** Discussion

### English Suh, Soon-Kyu Memorial Lecture Rm.300C

#### Breakthrough from Failing Hearts

Chairperson: Jae Ki Ko

- 10:20-10:45** Global Epidemics of Heart Failure  
Mary Norine Walsh/St. Vincent Health Center, USA
- 10:45-11:10** Multidisciplinary Approaches to Heart Failure Management: Targeting Comorbidities  
Stefan D. Anker/Medical University Goettingen, Germany

## 11:20-12:40

### Arrhythmia 5

Rm.103

#### Debate: Post-STAR AF2

Chairperson: 김유호  
Panel: 김영훈, 이만영

**11:20-11:30** Keynote Lecture: Interpretation of STAR AF2  
김영훈/고려의대

#### Debate: Is CPVI Enough for LONGSTANDING Persistent AF?

**11:30-11:40** Pros. CPVI Is Enough  
최기준/울산의대

**11:40-11:50** Cons. CPVI Is Not Enough  
박상원/세종병원

**11:50-12:00** Rebuttal & Discussion

#### Debate: What Should we do at Redo Ablation Procedure?

**12:00-12:10** Elimination of Recurrent Pulmonary Vein Potentials is Sufficient  
차태준/고신의대

**12:10-12:20** Additional Ablation After PVI  
오용석/가톨릭의대

**12:20-12:30** Rebuttal & Discussion

### Pediatric Cardiology

Rm.105

#### Pericardial Disease in Children

Chairpersons: 노정일, 홍영미  
Panel: 김시호, 오진희, 정수인

**11:20-11:35** Pericardium: What We Still Do Not Know? Epicardium in Cardiac Development and Disease  
김정선/성균관의대

**11:35-11:50** Normal Physiology of The Pericardium  
천은정/건양대의대

**11:50-12:05** Nonsurgical & Noninfectious Pericardial Disease  
한미영/경희대의대

**12:05-12:20** How to Evaluate Pericardial Disease in Congenital Heart Disease  
최은영/차의대

**12:20-12:35** Surgical Management of Pericardial Disease  
양지혁/성균관의대

**12:35-12:40** Discussion

### Imaging

Rm.205

#### Imaging of the Coronary Arteries and Ischemic Hearts: Current Issues

Chairpersons: 최연현, 조인호

**11:20-11:40** PET-MR and PET-CT for Coronary Artery Disease: Prime Time or Not?  
팽진철/서울의대

**11:40-12:00** Is Evaluation of Coronary Anatomy by CT Sufficient for CAD? Lessons and Un-Lessons from PROMISE  
윤환석/고려의대

**12:00-12:20** CMR Perfusion and Viability: A STICH Out of Time?  
장성아/성균관의대

**12:20-12:40** Echocardiography for Coronary Artery Disease – Strain or Not to Strain  
황희정/경희대의대

## 12:40-13:20

### Scientific Session-MSD

Rm.102

#### Challenging LDL-C Treatment Especially on ACS Patients

Chairpersons: 김동수, 권현철

**12:40-13:00** LDL-C Lowering Effects e, g. Coronary Plaque Progression/Regression Between Ezetimibe/Statin Versus Statin Alone in Patients Undergoing Percutaneous Coronary Intervention  
Kenichi Tsujita/Kumamoto Univ., Japan

**13:00-13:20** Beyond High Intensity Statin: Ezetimibe/Atorvastatin Combination Therapy  
한주용/성균관의대

## Scientific Session-AstraZeneca

Rm.103

### Address the CAD Challenge; The Patient-Centric Approach of Statin and OAP Treatment

Chairpersons: 김영대, 김두일

**12:40-13:00** Unanswered Question: Which Statin is the Most Cost-Effective in Korea?

서성환/동아의대

**13:00-13:20** Safeguarding the Future: How Can We Improve Outcomes in ACS Patients?

홍영준/전남의대

## Scientific Session-Samjin

Rm.105

### Focus on Rosuvastatin Under the Current Treatment Guideline of Hypercholesterolemia

Chairpersons: 윤정환, 임상욱

**12:40-13:00** Review of American & European Guideline - Stronger statin for 4 Groups with High Risk

김상현/서울의대

**13:00-13:20** Efficacy Evidence of Generic Rosuvastatin in 'NeustaR4G' Randomized Clinical Trial

원경현/서울의료원

## Scientific Session-Bayer

Rm.300C

### New Trends and Treatment of NOAC in AF Patients

Chairperson: 김재중

**12:40-13:00** Anticoagulation and AF: Real Life Data from the GARFIELD-AF Registry

오세일/서울의대

**13:00-13:20** Evidence Based Use of Rivaroxaban to Improve Outcomes in Patients with NVAf from Phase III to Real-World Evidence

강현재/서울의대

## 13:20-14:20

### Diamond Session-

### Daiichisankyo & Daewoong

Rm.205

### Adherence for Cardiovascular Disease Patients, "1 pill"

Chairpersons: 오동주, 이문형

**13:20-13:40** Ways to Improve Blood Pressure Control in Hypertension Patients

손일석/경희의대

**13:40-14:00** Safe and Convenient Anticoagulation Therapy for NVAf Patients

박형섭/계명대의대

## 14:20-15:40

### Women

Rm.102

### Microvascular Angina and Gender

Chairpersons: 심완주, 윤호중

Panel: 신미승, 신은석, 이상학

**14:20-14:50** What Is Microvascular Angina? Is It Gender Specific?

Amy W. Pollak/Mayo Clinic, USA

**14:50-15:00** Discussion

**15:00-15:15** How to Evaluate Microvascular Function and Angina?

윤명호/아주의대

**15:15-15:30** What Can We Do for the Patients with Microvascular Angina?

성기철/성균관대의대

**15:30-15:40** Discussion

### English Basic Research

Rm.103

### Regeneration and Metabolism

Chairpersons: Hyo-Soo Kim, Sang Hong Baek

Panel: Gi Seok Kim, Jeong Su Kim, GooBo Jeong

- 
- 14:20-14:40** Recovery of Myocardial Infarction via Unique Modulation of the Cardiac Microenvironment  
Youngkeun Ahn/Chonnam National Univ., Korea
- 14:40-15:10** Use of Cardiomyocytes Derived from Pluripotent Stem Cells for Cardiac Regeneration Therapy: Ready for the next stage  
Kiwon Ban/City University of Hong Kong, Hong Kong
- 15:10-15:30** The Role of Adipose Dysfunction in Heart Failure and Obesity  
Ippei Shimizu/Niigata Univ., Japan
- 15:30-15:40** Discussion

## Adult Congenital Heart Disease

Rm.105

### Changing Mortality and Morbidity

Chairpersons: 고재곤, 현명철  
Panel: 김여향, 유정진, 장기영

- 
- 14:20-14:40** Left Ventricular Hypertrophy on Electrocardio graphy: Clinic Implication in Adult Congenital Heart Disease  
Masaru Miura/Tokyo Metropolitan Children's Medical Center., Japan
- 14:40-15:00** Myocardial Fibrosis: Clinical Implication in Adult Congenital Heart Disease  
허준/성균관대
- 15:00-15:15** How to Control Cardiovascular Risk Factors in ACHD  
김계훈/전남대
- 15:15-15:30** End-of-Life Care in Adults with Congenital Heart Disease  
은영민/연세대

## Smart Cardiovascular Healthcare

Rm.205

Chairpersons: 김윤년, 박승우

- 
- 14:20-14:40** Smart Healthcare for Cardiovascular Disease  
박승우/성균관대
- 14:40-15:00** Smart Health for Chronic Diseases Prevention and Care  
박현영/국립보건연구원
- 15:00-15:20** "Dr. M" Project – KAIST Smart Mobile Healthcare Innovations  
정윤철/한국과학기술원
- 15:20-15:35** Utilization of Medical Big Data for Cardiovascular Healthcare  
김영학/울산대
- 15:35-15:40** Discussion

## Arrhythmia 6

Rm.300C

### Case Based Tutorial: Hypertrophic Cardiomyopathy

Chairperson: 정병천  
Panel: 배은정, 신동구

- 
- 14:20-14:40** Keynote Lecture: HCM with Septal vs. Apical Hypertrophy  
심지영/연세대
- 14:40-14:55** Case 1. Syncope with HCM: Hemodynamic or Arrhythmic?  
최의근/서울대
- 14:55-15:10** Case 2. Atrial Fibrillation with Hypertrophic Cardiomyopathy and Stroke Prevention  
김진석/고려대
- 15:10-15:25** Case 3. HCM: Optimal ICD Programming  
오일영/서울대

## 15:50-17:20

## Nursing in Cardiac Critical Care Units

Rm.102

### New Trend of Cardiology Nursing Intervention

Chairpersons: 김필자, 김현주

- 
- 15:50-16:10** Cardiac Imaging for Nursing  
김현주/연세대 세브란스병원
- 16:10-16:30** Coronary Artery Disease and Current Nursing Care  
최남경/성균관대 삼성서울병원
- 16:30-16:50** Percutaneous Intervention of Heart Valve Disease and Nursing Care  
송현주/서울대학교병원
- 16:50-17:10** Nursing Management of Patients with Arrhythmia  
강영애/울산대 아산병원

## Basic Research

Rm.103

### Signaling

Chairpersons: 전은석, 박현영  
Panel: 임병관, 정보영, 진선아

- 
- 15:50-16:10** Utility of Circulating MicroRNAs in Cardiovascular Disease  
민필기/연세의대
- 16:10-16:30** Shear Stress-Mediated Calcium Signaling in Cardiac Myocytes  
우선희/충남대학교
- 16:30-16:50** Depletion of The Cerblon Gene Enhances Cardiac Contractility, CA2<sup>+</sup> Transient and Mitochondrial Energy Metabolism in Mice  
김형규/인제대학교
- 16:50-17:10** CD82/KAI1 Maintains the Dormancy of Long-Term Hematopoietic Stem Cells through Interaction with DARC-Expressing Macrophages  
허진/서울대학교
- 17:10-17:20** Discussion

## Pediatric & Congenital Cardiac Surgery **Rm.105**

### Debate on the Management of LV Outflow Tract Issues

Chairpersons: 김성호, 박영환

#### Case: Neonate with Severe Aortic Stenosis, Dysplastic AV, LV Mild Dysfunction

- 15:50-16:00** Surgery  
이창하/세종병원
- 16:00-16:10** Intervention  
김기범/서울의대
- 16:10-16:15** Rebuttal

#### Case: 42yr Old Male with Severe AR, Mild LV Dysfunction S/P TOF

- 16:15-16:25** AV Replacement using tissue valve  
김경환/서울의대
- 16:25-16:35** AV Replacement (Mechanical Valve)  
김육성/성균관대의대
- 16:35-16:40** Rebuttal

#### Case: 15yr Old Boy with Severe AR, Mod AS, Bicuspid AV

- 16:40-16:50** AV Replacement (Tissue Valve) or AV Plasty  
윤태진/울산의대
- 16:50-17:00** Ross Procedure in Young Patients  
김웅환/서울의대
- 17:00-17:10** Rebuttal

## Vascular

**Rm.205**

### Functional Assessment from Non-Invasive Imagings of Atherosclerotic Vascular Beds

Chairpersons: 오구택, 조구영

Panel: 이상학, 이해영, 최진호

- 
- 15:50-16:10** Computational Modeling of Atherosclerotic Arteries  
김나리/인제대의대
- 16:10-16:30** Noninvasive Fractional Flow Reserve from Coronary CT Angiography  
구본권/서울의대
- 16:30-16:50** Functional Assessment of Carotid-Cerebral Artery from Noninvasive Imaging  
강현승/서울의대
- 16:50-17:10** Discussion

## Arrhythmia 7

**Rm.300C**

### Debate: Valvular AF

Chairperson: 황교승

Panel: 이문형, 정동섭

- 
- 15:50-16:00** Keynote Lecture: SND and AF, Same Disease or Just Associated Phenomenon?  
남기병/울산의대

### Debate: Post-Maze Sick Sinus Node Syndrome, Followed by AF Recurrence

- 16:00-16:15** Pros. Back to Rate Control  
엄재선/연세의대
- 16:15-16:30** Cons. Pacemaker & Further Rhythm Control  
심재민/고려의대
- 16:30-16:40** Rebuttal and Discussion

### Debate: Recurrent Stroke Under Anticoagulation in Mild MS & AF

- 16:40-16:55** Prefers WATCHMAN  
윤영근/성균관대의대
- 16:55-17:10** Prefers Mini-Maze  
이승현/연세의대
- 17:10-17:20** Rebuttal and Discussion



## Program KSIC 대한심혈관중재학회

**15** April 15 Fri.  
08:30-09:50

### KSIC 1 Rm.102

#### All You Need to Know: Non Invasive Evaluation for Chest Pain

Chairpersons: 김영조, 안태훈  
Panel: 권성욱, 임영호, 홍영준

- 08:30-08:45 ECG and Treadmill Test  
오석규/원광의대
- 08:45-09:00 Myocardial Spect  
김영학/울산의대
- 09:00-09:15 Stress Echocardiography  
홍그루/연세의대
- 09:15-09:30 CT Angiography  
최진호/성균관대의대
- 09:30-09:50 Discussion

10:20-11:10

### Key Note KSIC Rm.102

#### What you Have to Learn

Chairpersons: 박승정, 장양수

- 10:20-10:45 TAVI  
김효수/서울의대
- 10:45-11:10 CPR Guideline  
나상훈/서울의대

11:20-12:40

### KSIC 2 Rm.102

#### All About BVS

Chairpersons: 탁승제, 임도선  
Panel: 이철환, 최소연, 한주용

- 11:20-11:35 IPOP: Imaging and Physiology of BVS  
김병국/연세의대

- 11:35-11:50 PRG: Optimal Antiplatelet Therapy for BVS  
정영훈/경상의대
- 11:50-12:05 SFR: Scaffold Failure of BVS  
허승호/계명의대
- 12:05-12:20 Perspective of BVS  
신은석/울산의대
- 12:20-12:40 Discussion

**16** April 16 Sat.  
08:30-09:50

### KSIC 3 Rm.300C

#### Forgotten Vessel; Vein

Chairpersons: 정옥성, 윤정환  
Panel: 고영국, 유상용, 정재승

- 08:30-08:45 Acute Care of VTE: Anticoagulation and Thrombolysis  
양정훈/삼성서울병원
- 08:45-09:00 Long-term Management of VTE  
배장환/충북의대
- 09:00-09:15 Interventional Management of Chronic Venous Thromboembolism  
Michael Park/Cleveland Clinic, USA
- 09:15-09:30 Management of Post-Thrombotic Syndrome - Focused on Intervention and Surgery  
Michael Park/Cleveland Clinic, USA
- 09:30-09:50 Discussion

11:20-12:40

### English KSIC 4 Rm.300C

#### Beyond Coronary Angiography

Chairpersons: 김무현, 김효수  
Panel: 남창욱, 김수중, 김상욱

- 11:20-11:40 Physiology  
구분권/서울의대
- 11:40-12:00 Imaging  
Ik Kyung Jang/Massachusetts General Hospital, USA
- 12:00-12:20 Outcome  
홍명기/연세의대
- 12:20-12:40 Discussion

## Program KSE 한국심초음파학회

**15** April 15 Fri.  
14:20-15:40

### KSE 1 Rm.102

#### Issue & Updates in Myocardial & Pericardial Diseases

Chairpersons: 정남식, 채성철

- 14:20-14:35** Cardiac Sarcoidosis  
송재관/울산의대
- 14:35-14:50** Fabry Disease  
홍그루/연세의대
- 14:50-15:05** Constrictive Pericarditis  
Jae K. Oh/Mayo Clinic, USA
- 15:05-15:20** Acute & Fulminant Myocarditis  
최진오/성균관대의대
- 15:20-15:40** Q & A

**16:20-17:40**

### KSE 2 Rm.102

#### Learning from Cases & Echocardiography [1]

Chairpersons: 정상만, 김용욱

Panel: 김형섭, 박정량, 조은주

- 16:20-16:35** Myocardial Disease  
최의영/연세의대
- 16:35-16:50** Pericardial Disease  
신미승/가천의대
- 16:50-17:05** Adult Congenital Heart Disease  
손일석/경희의대
- 17:05-17:20** Aorta Disease  
박용현/부산의대
- 17:20-17:40** Discussion

**16** April 16 Sat.  
08:30-09:50

### KSE 3 Rm.102

#### Issue & Updates in Valvular Heart Disease

Chairpersons: 손대원, 박종춘

- 08:30-08:45** Benefit of Surgery for Secondary Mitral Regurgitation  
강덕현/울산의대
- 08:45-09:00** Etiology of Valvular Heart Disease in Korea  
박승우/성균관대의대
- 09:00-09:15** Surgical & Transcatheter Interventions of Aortic Stenosis  
박성지/성균관대의대
- 09:15-09:30** Surgical Management of Aortic Root Disease  
주석중/울산의대
- 09:30-09:50** Q & A

**11:20-12:40**

### KSE 4 Rm.102

#### Learning from Cases & Echocardiography [2]

Chairpersons: 김원호, 신준환

Panel: 김학령, 박찬석, 윤현주

- 11:20-11:35** Mitral Regurgitation  
설상훈/인제의대
- 11:35-11:50** Mitral Stenosis  
김장영/연세원주의대
- 11:50-12:05** Aortic Regurgitation  
신진호/함양의대
- 12:05-12:20** Aortic Stenosis  
양동현/경북의대
- 12:20-12:40** Discussion

## Program KSLA 한국지질·동맥경화학회

**15** April 15 Fri.  
**08:30-10:10**

### KSLA 1 Rm.105

#### Autophagy and Atherosclerosis

Chairpersons: 박영배, 박경수  
Panel: 김재택, 한진, 조경현, 조정현

- 08:30-08:50** Autophagy Overview and Its Role in Vascular Biology  
이용호/연세의대
- 08:50-09:10** The Regulation of Autophagy and ROS Axis in Fatty Liver Disease  
배수한/연세의대
- 09:10-09:30** The Role of Peroxiredoxins in Autophagic Flux in the Pathogenesis of Atherosclerosis  
오구택/이화여대
- 09:30-09:50** Molecular Mechanism of Parkin/PINK1-Mediated Mitochondrial Degradation via Autophagy Pathway  
Koji Yamano/Tokyo Metropolitan Institute of Medical Science, Japan
- 09:50-10:10** Discussion

**10:20-11:10**

### KSLA 2 Rm.105

#### Keynote Lecture

Chairperson: 김덕경

- 10:20-11:10** A Novel Link Between Inhibition of Angiogenesis and Tolerance to Vascular Stress  
Yasufumi Sato/Tohoku Univ., Japan

**11:10-12:40**

### KSLA 3 Rm.105

#### Nutrition and Atherosclerosis

Chairpersons: 서홍석, 김양하  
Panel: 김오연, 김혜진, 정창희

- 11:10-11:35** Dietary Cholesterol and Cardio-Metabolic Health  
양수진/서울여대

- 11:35-12:00** What You Eat Matters to Your Grandchildren-Epigenetic Inheritance  
박윤정/이화여대
- 12:00-12:25** From Feast to Famine: Biology and Pharmacology of Fibroblast Growth Factor 1  
서재명/카이스트
- 12:25-12:40** Discussion

**14:20-16:00**

### KSLA 4 Rm.105

#### Lessons Learned from Recent CV Outcome Trials

Chairpersons: 신현호, 김치정  
Panel: 김병진, 송기호, 서지아, 조상호

##### Part I: Lessons Learned from CV Outcome Trials Using New Anti-Diabetic Therapy

- 12:20-14:40** CV Outcome Trials of Incretin Therapy (SAVOR-TIMI 53, EXAMINE, TECOS, ELIXA)  
김성래/가톨릭의대
- 14:40-15:00** Cardiovascular Outcome of SGLT2i (EMPA-REG OUTCOME)  
조영민/서울의대

##### Part II: Lessons Learned from CV Outcome Trials Using LDL-C-Lowering Medications

- 15:00-15:20** High-Intensity Statin  
한기훈/울산의대
- 15:20-15:40** Statin+Ezetimibe  
김상현/서울의대
- 15:40-16:00** Discussion

**16:10-17:40**

### KSLA 5 Rm.105

#### Special Debate Session: Do We Need Surrogate Markers or Not?

Chairperson: 이문규  
Panel: 이해영, 박성하, 최소연, 김대중, 권혁상

- 16:10-16:20** Introduction  
이문규/성균관대의대
- 16:20-16:45** Pros  
성기철/성균관대의대
- 16:45-17:10** Cons  
김신근/교려의대
- 17:10-17:40** Discussion



## 대한심장학회가 함께하는 '우리가족 심장 지킴이' 앱을 만나보세요!



모바일앱 하나로 보다 **쉽고 간편하게**  
심장건강을 관리하실 수 있습니다.



### APP 설치 방법

- QR 코드를 스캔하시면 자동으로 앱이 설치됩니다.
- 플레이 스토어(안드로이드폰) 또는 앱스토어(아이폰)에서 '대한심장학회'를 검색하셔서 다운로드 받으시면 됩니다.



대한심장학회  
The Korean Society of Cardiology

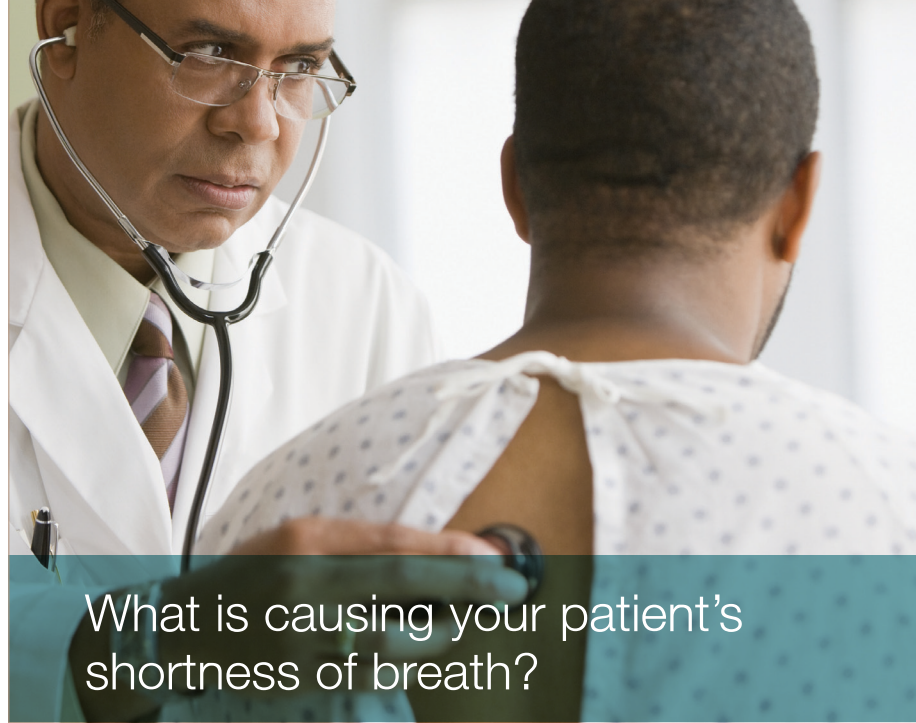

## What is causing your patient's shortness of breath?

With the Alere Triage® System, Alere can help improve treatment decisions now.

Patients presenting with shortness of breath provide a real challenge. Are the symptoms caused by Heart Failure, Pulmonary Embolism, COPD, or some other respiratory ailment? Having answers **now** will help to support appropriate treatment decisions.

- Results available in 15–20 minutes with minimal hands-on time
- The only CLIA-waived test for BNP
- Allows for patient assessment while the patient is still present



Alere Triage® MeterPro  
Alere Triage® BNP Test  
Alere Triage® Cardio3 Panel\*  
Alere Triage® D-Dimer Test



Alere™ Knowing now matters.®

Alere Healthcare, Inc.  
경기도 성남시 분당구 정자동 166 SPG 빌딩 5층 (13558)  
Tel : 031-8014-6700 Fax: 031-8014-6799

031-8014-6700 | alere.com

\*Tests available for the Alere Triage Cardio3 Panel are BNP, CK-MB and Troponin I

© 2016 Alere. All rights reserved. The Alere Logo, Alere, Knowing now matters, MeterPro and Triage and are trademarks of the Alere group of companies. The photo is for illustrative purposes only. Any person depicted in the photo is a model. 10002601-01 3/16





2016년 2016 Annual Spring Scientific Conference of the KSC  
in conjunction with KSCF, KCS, and KOLA  
대한심혈관학회 16회 춘계심혈관학술대회 | 한국심장학회 | 한국진단 심혈관학회

# 춘계심혈관통합학술대회

The 8<sup>th</sup> Asian Pacific Congress of Heart Failure

## & 제8회 아시아·태평양 심부전학술대회

Diamond Sponsors

---



Boehringer  
Ingelheim



Bayer



Daiichi-Sankyo



DAEWOOONG